

Caletta  
168

polished version

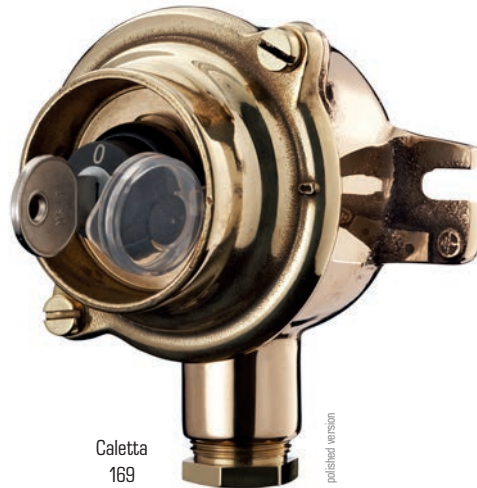

Caletta  
169

polished version

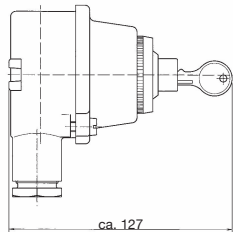
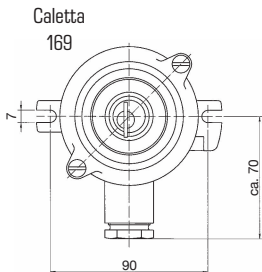
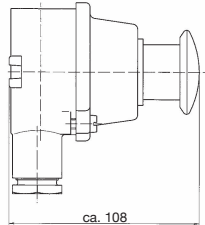
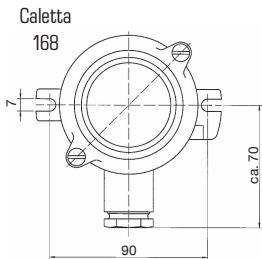

### Technical Data

Name & No.	Diagram	kg	Description
Caletta 168	O-	0,80	<ul style="list-style-type: none"> <li>emergency switch-off button</li> <li>IP56</li> </ul>
Caletta 168/2	O=	0,93	<ul style="list-style-type: none"> <li>brass casing and cover</li> <li>cable gland: M24x1.5</li> <li>und detachable cover screws M6, plastic contact interior for 1-pole working current and closed circuit current 380/500V AC 10A</li> </ul>
Caletta 168/D	-O-	0,91	<ul style="list-style-type: none"> <li>max. 500V AC at 2A/max. 220V DC at 0,3A</li> <li>6A</li> <li>depressed position blocks contacts, deblocking by strong pulling</li> </ul>
Caletta 169	O-	0,80	<ul style="list-style-type: none"> <li>key switch</li> <li>IP56</li> </ul>
Caletta 169/2	O=	0,93	<ul style="list-style-type: none"> <li>brass casing and cover</li> <li>cable gland: M24x1.5</li> <li>und detachable cover screws M6, plastic contact interior for 1-pole working current and closed circuit current 380/500V AC 10A</li> </ul>
Caletta 169/D	-O-	0,91	<ul style="list-style-type: none"> <li>max. 500V AC at 2A/max. 220V DC at 0,3A</li> <li>6A</li> <li>key can be removed in on- and -off-positions</li> </ul>

Polished products available for an extra charge.

